

WASHER MOTOR

COMPONENTS

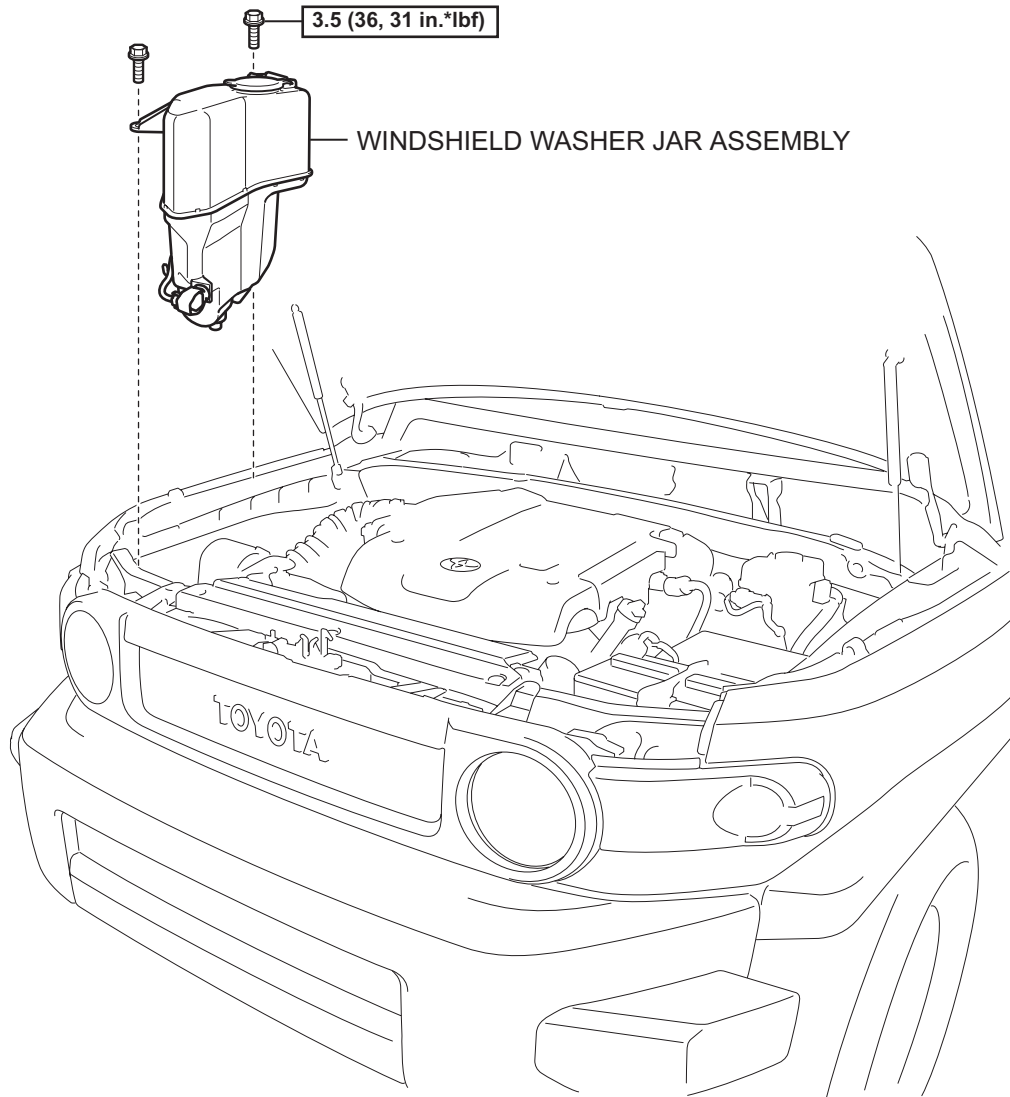

N*m (kgf*cm, ft*lbf) : Specified torque

w/o Rear Wiper:

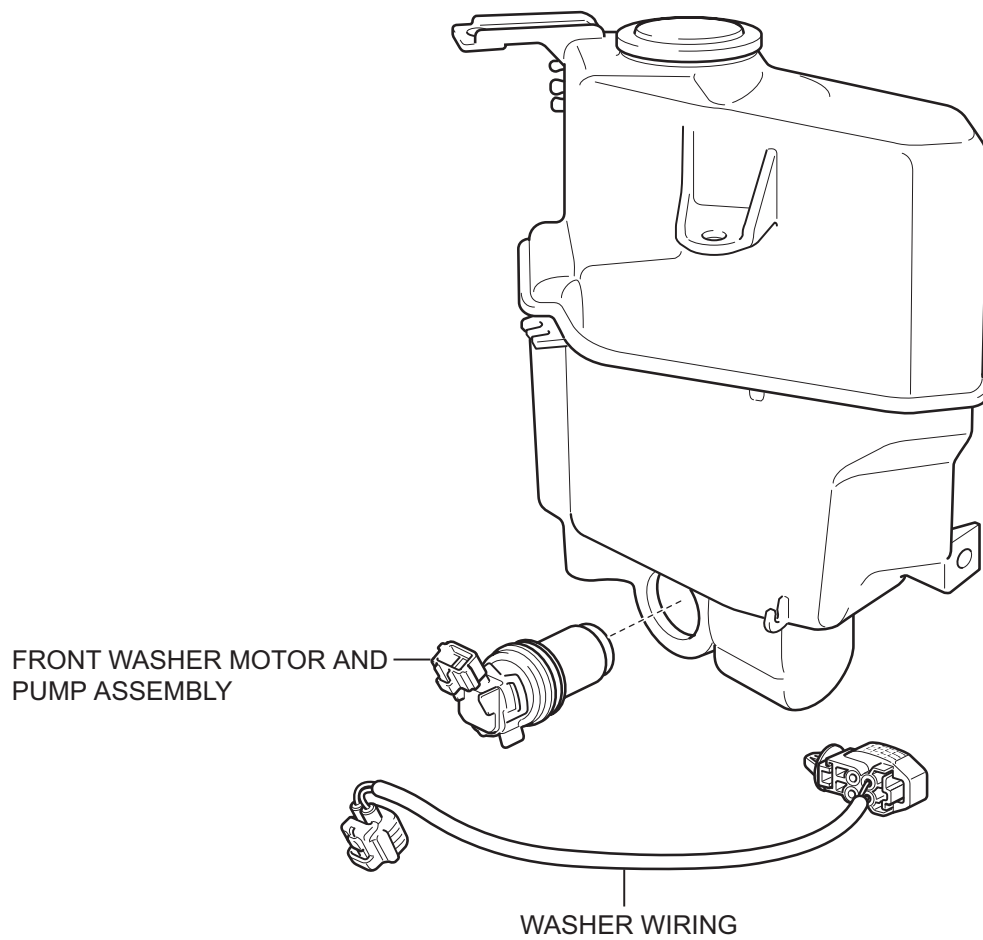

WW

w/ Rear Wiper:

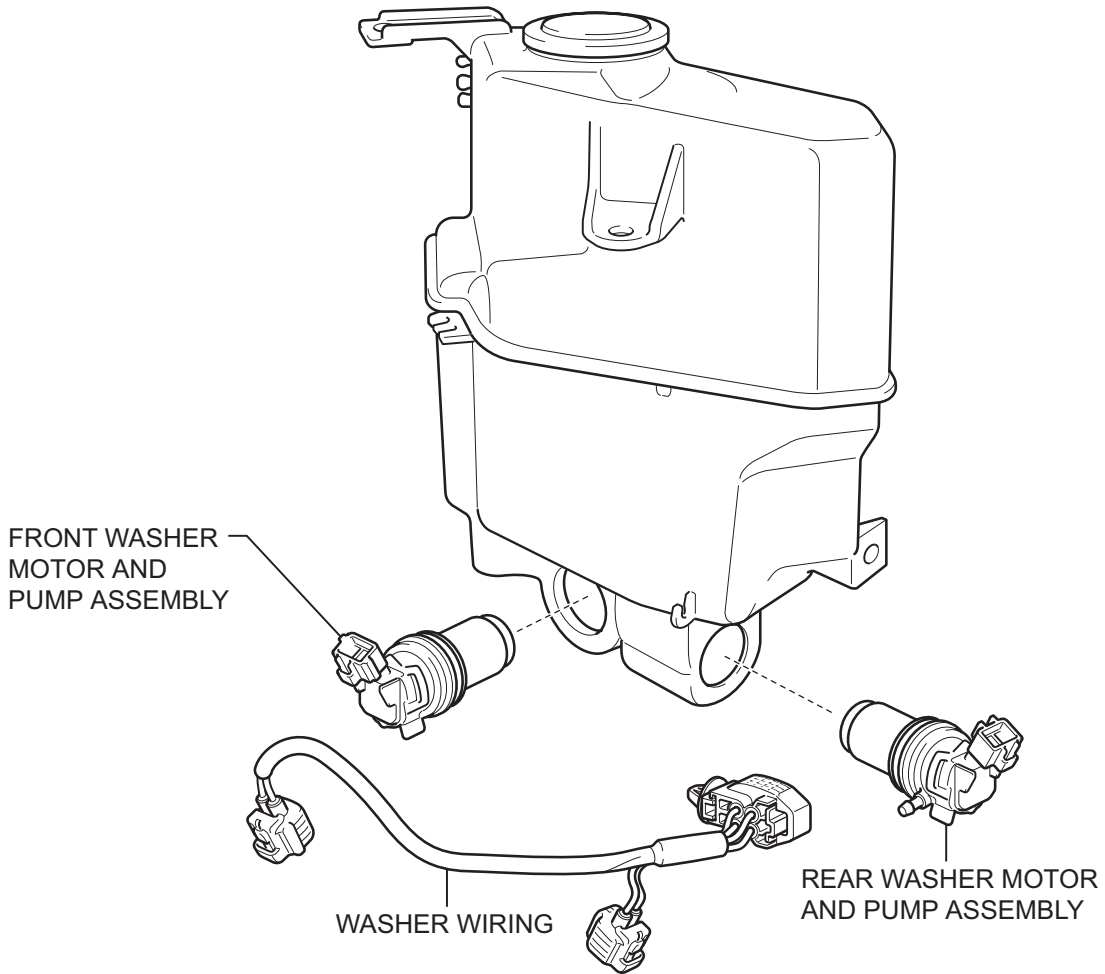

WW

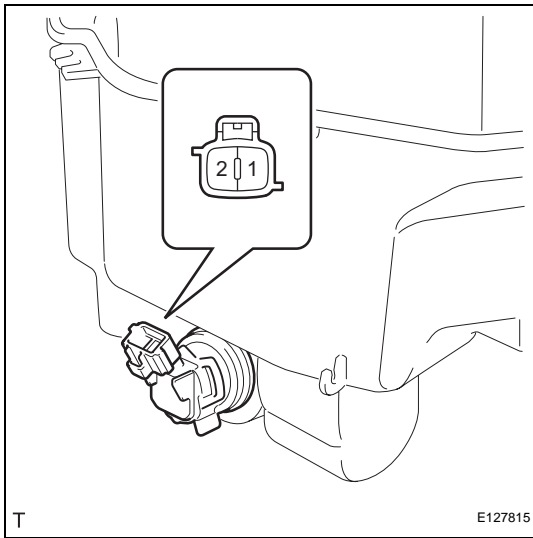

ON-VEHICLE INSPECTION

1. INSPECT FRONT WASHER MOTOR AND PUMP ASSEMBLY

- (a) Check the operation of the windshield washer motor and pump front side.

- (1) Fill the washer jar with washer fluid.

HINT:

The operation should be performed with the windshield washer motor and pump installed on the washer jar.

- (2) Connect the positive (+) battery lead to terminal 1 of the windshield washer motor and pump, and the negative (-) battery lead to terminal 2. Check that washer fluid flows from the washer jar.

Standard:

Washer fluid flows from the washer jar.

If the result is not as specified, replace the windshield washer motor and pump.

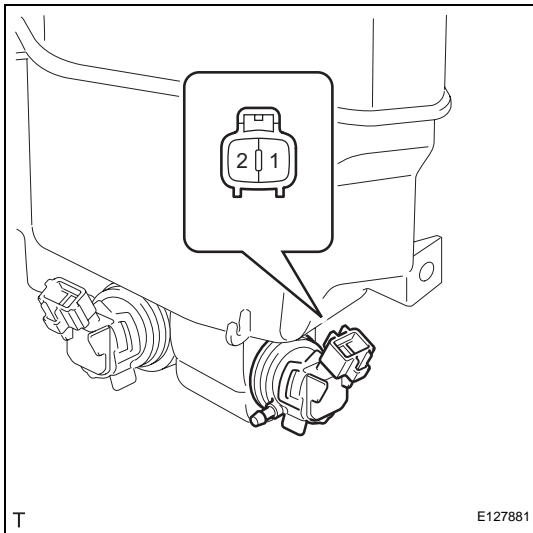

2. INSPECT REAR WASHER MOTOR AND PUMP ASSEMBLY (w/ Rear Wiper)

- (a) Check the operation of the windshield washer motor and pump rear side.

- (1) Fill the washer jar with washer fluid.

HINT:

The operation should be performed with the windshield washer motor and pump installed on the washer jar.

- (2) Connect the positive (+) battery lead to terminal 1 of the windshield washer motor and pump, and the negative (-) battery lead to terminal 2. Check that washer fluid flows from the washer jar.

Standard:

Washer fluid flows from the washer jar.

If the result is not as specified, replace the windshield washer motor and pump.